

ALBERTON PRIMARY SCHOOL

Supervision and Yard Duty Policy



Help for non-English speakers

If you need help to understand this policy, please contact Alberton Primary School on 0351832412.

PURPOSE

To ensure school staff understand their supervision and yard duty responsibilities.

SCOPE

This policy applies to all teaching and non-teaching staff at Alberton Primary School, including education support staff, casual relief teachers and visiting teachers.

POLICY

Appropriate supervision is an important strategy to monitor student behaviour and enables staff to identify and respond to possible risks at school as they arise. It also plays a vital role in helping schools to discharge their duty of care to students.

The principal is responsible for ensuring that there is a well organised and responsive system of supervision and yard duty in place during school hours, before and after school, and on school excursions and camps and other school activities.

School staff are responsible for following reasonable and lawful instructions from the principal, including instructions to provide supervision to students at specific dates, times and places. Supervision should be undertaken in a way that identifies and mitigates risks to child safety.

1. Before and after school

Alberton Primary School's grounds are supervised by school staff from 8.30am until 3.40pm. Children arriving at school prior to 8.30am will be asked to come inside to read quietly while staff are doing their preparation in the classroom. Outside of these hours, school staff will not be available to supervise students.

Families are encouraged to contact the office on 0351832412 for more information about the before and after school care facilities available to our school community.

Parents and carers will be advised through CLASSDOJO and the NEWSLETTER that they should not allow their children to attend Alberton Primary School outside of these hours. Families are encouraged to contact our school for more information about the before and after school care facilities available to our school community.

If a student arrives at school before supervision commences at the beginning of the day, the principal or nominee staff member will, as soon as practicable, follow up with the parent/carer to:

- advise of the supervision arrangements before school
- request that the parent/ carer make alternate arrangements.

If a student is not collected before supervision finishes at the end of the day, the principal or nominee staff member will consider whether it is appropriate to:

- attempt to contact the parents/carers
- attempt to contact the emergency contacts
- place the student in an out of school hours care program (if available)
- contact Victoria Police and/or the Department of Health and Human Services (Child Protection) to arrange for the supervision, care and protection of the student.

School staff who are rostered on for before or after school supervision must follow the processes outlined below.

2. Yard Duty

All staff at Alberton Primary School are expected to assist with yard duty supervision and will be included in the weekly roster.

The principal or alternative nominee is responsible for preparing and communicating the yard duty roster on a regular basis. At Alberton Primary School, school staff will be designated a specific time to do yard duty.

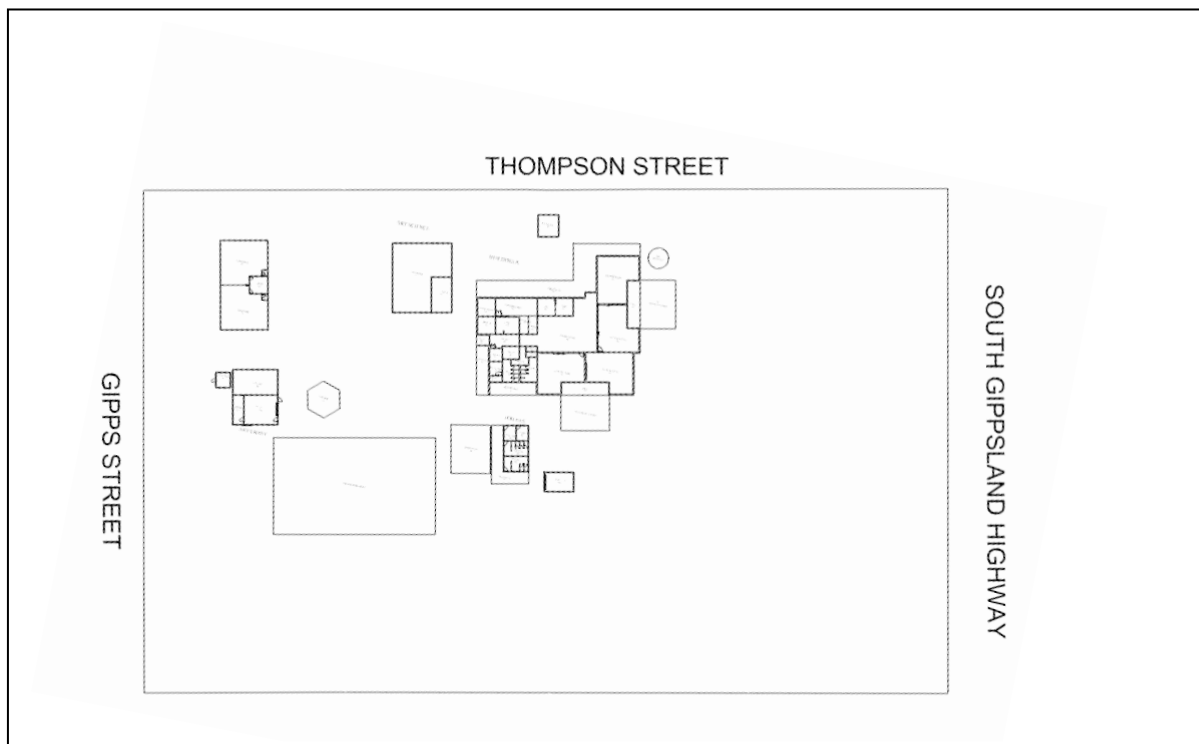

School staff must wear a provided safety/hi-vis vest whilst on yard duty. Safety/hi-vis vests will be stored in the staff room.

Staff who are rostered for yard duty must remain in the designated area until they are replaced by a relieving teacher.

During yard duty, supervising staff must:

- methodically move around the school
- be alert and vigilant
- intervene immediately if potentially dangerous or inappropriate behaviour is observed in the yard
- enforce behavioural standards and implement appropriate consequences for breaches of safety rules, in accordance with any relevant disciplinary measures set out in your school's *Student Engagement and Wellbeing* policy
- ensure that students who require first aid assistance receive it as soon as practicable
- log any incidents or near misses as appropriate
- if being relieved of their yard duty shift by another staff member (for example, where the shift is 'split' into 2 consecutive time periods), ensure that a brief but adequate verbal 'handover' is given to the next staff member in relation to any issues which may have arisen during the first shift.

If the supervising staff member is unable to conduct yard duty at the designated time, they should contact the principal with as much notice as possible prior to the relevant yard duty shift to ensure that alternative arrangements are made.

If the supervising staff member needs to leave yard duty during the allocated time, they should contact the principal but should not leave the designated area until the relieving staff member has arrived in the designated area.

If a relieving or next staff member does not arrive for yard duty, the staff member currently on duty should send a message to the office and not leave the designated area until a replacement staff member has arrived.

Should students require assistance during recess or lunchtime, they are encouraged to speak to the supervising yard duty staff member.

3. Classroom

The classroom teacher is responsible for the supervision of all students in their care during class.

If a teacher needs to leave the classroom unattended at any time during a lesson, they should first contact the office for assistance. The teacher should then wait until another staff member has arrived at the classroom to supervise the class prior to leaving.

4. School activities, camps and excursions

The principal and leadership team are responsible for ensuring that students are appropriately supervised during all school activities, camps and excursions, including when external providers are engaged to conduct part or all of the activities. Appropriate supervision will be planned for special school activities, camps and excursions on an individual basis, depending on the activities to be undertaken and the level of potential risk involved.

5. Digital devices and virtual classroom

Alberton Primary School follows the Department's [Cybersafety and Responsible Use of Technologies Policy](#) with respect to supervision of students using digital devices.

[include if your school has students participating in virtual and remote learning on school site (for example a program or class that is delivered virtually, off-site, by another school or instructor while the student remains on-site at your school)] Alberton Primary School will also ensure appropriate supervision of students participating in remote and flexible learning environments while on school site. In these cases, students will be supervised [include content on where students will undertake virtual and remote learning while at school e.g. the library/break out space/ common area].

[Include if your school has any students participating in remote and virtual learning from home] While parents are responsible for the appropriate supervision of students accessing virtual classrooms from home:

student attendance will be monitored [insert arrangement at your school, for example daily/every class]

any wellbeing or safety concerns for the student will be managed in accordance with our usual processes – refer to our Student Wellbeing and Engagement Policy and our Child Safety Responding and Reporting Policy and Procedures for further information.

6. Students requiring additional supervision support

Sometimes students will require additional supervision, such as students with disability or other additional needs. In these cases, the principal or delegate will ensure arrangements are made to roster additional staff as required. This may include on yard duty, in the classroom or during school activities.

teacher. Students will not be permitted to leave school grounds during these sessions.

7. Supervision of student in emergency operating environments

In emergency circumstances our school will follow our Emergency Management Plan, including with respect to supervision.

In the event of any mandatory period of remote or flexible learning our School will follow the operations guidance issued by the Department.

COMMUNICATION

This policy will be communicated to our school community in the following ways:

- Included in staff induction processes
- Discussed at staff briefings or meetings, as required
- Included in our staff handbook
- Included as a reference in our school newsletter each term
- Made available in hard copy from school administration upon request
- Information for parents and students on supervision before and after school is available on our school website and parent reminders are sent at the beginning of each term in our school newsletter.

FURTHER INFORMATION AND RESOURCES

This policy should be read in conjunction with the following policies on the Department’s Policy and Advisory Library (PAL):

- Child Safe Standards
- Cyber safety and Responsible Use of Technologies
- Duty of Care
- Excursions
- School Based Apprenticeships and Traineeships
- School Community Work
- Structured Workplace Learning
- Supervision of Students
- Visitors in Schools
- Work Experience

POLICY REVIEW AND APPROVAL

Policy last reviewed	15/9/2023
Approved by	Principal – Malissa Nicol
Next scheduled review date	15/8/2025 (review every 2 years)

This policy will also be updated if significant changes are made to school grounds that require a revision of Alberton Primary School’s yard duty and supervision arrangements.